

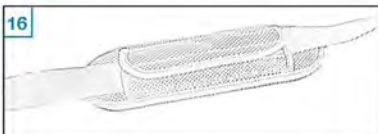

Carbon fiber cello case

Carrying in front

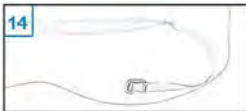
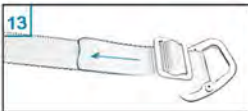
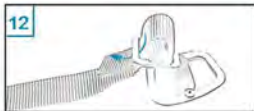
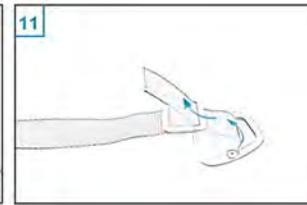
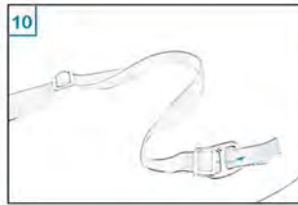
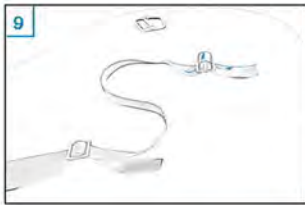
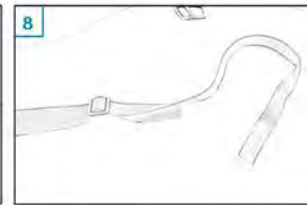
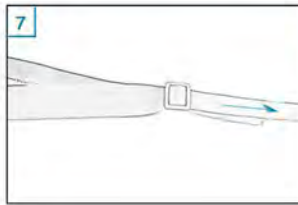
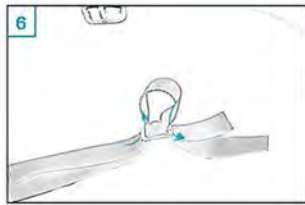
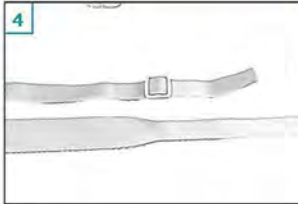
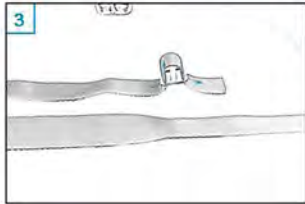
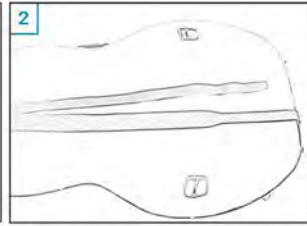
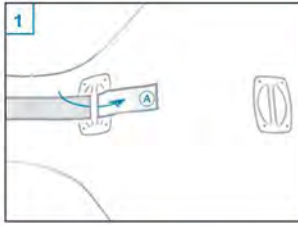
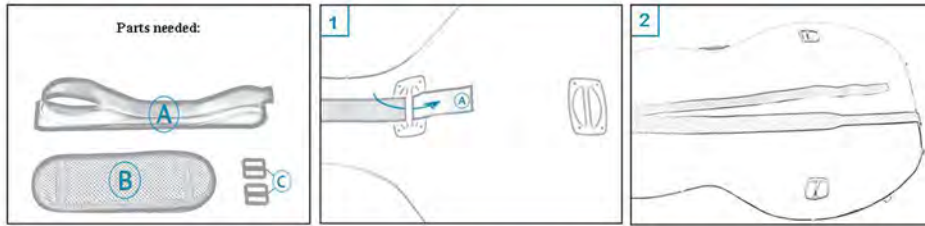

Carbon fiber cello case

Comfort system

*Optional accessory:*

*With detachable music sheet pocket and detachable cushion for the best carrying comfort.*

# Comfort system



[info@musilia.com](mailto:info@musilia.com)

The Musilia carbon fiber cello case uses a revolutionary carrying system that is absolutely safe for your instrument. Simple and effective, it consists of one single nylon strap that can be used in three different ways.

**Musilia** Carbon fiber cello case Backpack system

Parts needed:

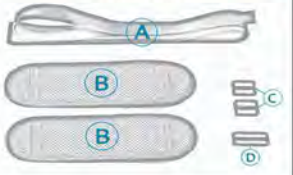

1. Attach strap A to the top handle of the case.
2. Thread the strap through the top handle.
3. Attach the buckle C to the strap.
4. Attach the buckle C to the bottom handle of the case.
5. Buckle the strap across the top handle.
6. Thread the strap through the bottom handle.
7. Attach the pad B to the bottom handle.
8. Buckle the strap across the bottom handle.
9. Attach the pad B to the top handle.
10. Buckle the strap across the top handle.
11. Buckle the strap across the bottom handle.
12. Buckle the strap across the top handle.
13. Buckle the strap across the bottom handle.
14. Buckle the strap across the top handle.

Now do the same on the other side, starting from picture No. 7

**Musilia** Carbon fiber cello case Carrying on one side

Parts needed:

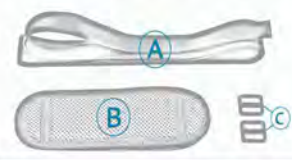

1. Attach strap A to the top handle of the case.
2. Thread the strap through the top handle.
3. Attach the buckle C to the strap.
4. Attach the buckle C to the bottom handle of the case.
5. Buckle the strap across the top handle.
6. Buckle the strap across the bottom handle.
7. Attach the pad B to the bottom handle.
8. Buckle the strap across the bottom handle.
9. Attach the pad B to the top handle.
10. Buckle the strap across the top handle.
11. Buckle the strap across the bottom handle.
12. Buckle the strap across the top handle.
13. Buckle the strap across the bottom handle.
14. Buckle the strap across the top handle.

